



ELECTRONIC LOCK

PRISMA

PRISMA THE IDEAL
REPLACEMENT FOR
MECHANICAL LOCKING
SYSTEMS.

Prisma is the ideal entry level electronic lock, allowing facilities to quickly upgrade and secure their lockers, enclosures or other storage units, rather than using basic key cams or hasps.



INTELLIGENT LOCKING SYSTEMS



ELECTRONIC LOCK

PRISMA

MAIN FEATURES

- ✓ **Non Handed** > Unit fits LH or RH doors.
- ✓ **ADA Compliant** > Standard supply.
- ✓ **IP 55 Rated** > High level resistance to water and dust.
- ✓ **CodeSafe** > Prevents unauthorized codes being stored in unlocked position.
- ✓ **Buttons** > Tactile soft touch with large, high contrast clear digits.
- ✓ **Simple installation** > Easy key / hasp retrofit or new install.
- ✓ **Flexible** > Lock can be switched between free or assigned mode.
- ✓ **Battery override** > External power override for emergency opening.
- ✓ **LED status indicators** > Shows if a lock is occupied.
- ✓ **4 levels of code management** > Master, Submaster, User, Service.
- ✓ **Battery status indicator** > Gives visual battery level.

FLASH				
More than 80% charged	● ● ● ● ●	● ● ● ● ●	● ● ● ● ●	● ● ● ● ●
Between 50%-80% charged	● ● ● ● ●	● ● ● ● ●	● ● ● ● ●	
Between 20%-50% charged	● ● ● ● ●	● ● ● ● ●		
Less than 20% charged	● ● ● ● ●			



NOTE:
Version with mechanical emergency opening available.

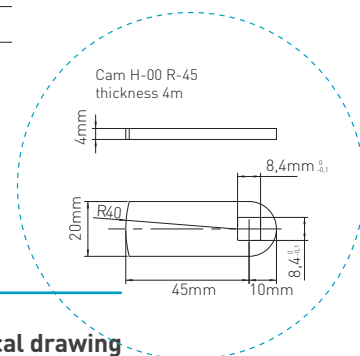

Programming

The prisma has four levels of codes available:

Level 1_8 digit Master code can:

- Open and close the lock
- Change master code
- Set / Change / Delete user and submaster code
- Select private or public function
- Activate / Deactivate service code

level 2_8 digit Submaster code can:

- Open and close the lock
- Change the submaster code
- Set / Change / Delete user code

level 3_4 digit User code can:

- Open and close the lock
- Change the submaster code

level 4_6 digit Service Code can:

- Open and close the lock (without deleting user code)

Technical specification

External dimensions	> L=148mm, W=33mm
IP Rating	> IP55
Batteries	> 2 x AAA 1.5v
Openings	> 15.000 (Approx 3 years battery life)
Material	> Zamac
Door thickness	> Up to 20cm.
Finish	> Matt black. (other finishes on request)
Handing	> Non handed suitable for LH or RH door
Keypad Code combinations	> Master & Submaster code: 100,000,000 > Service code: 1,000,000 > User code: 10,000

Technical drawing

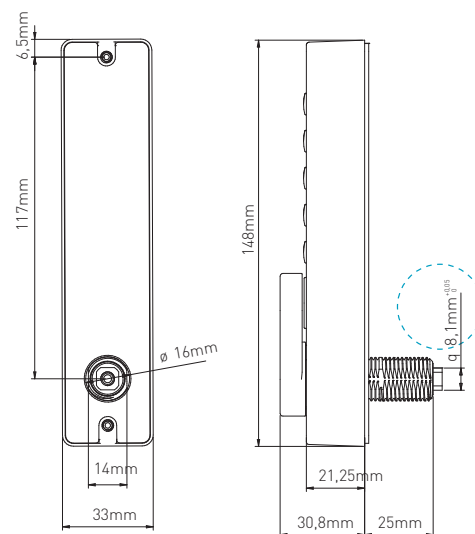

INTELLIGENT LOCKING SYSTEMS

CONTACT
E. sales@ojmar.com
T. +34 943 748484

OJMAR S.A.
Polígono Industrial de Lerun, s/n
20870 Elgoibar · Spain

WWW
www.ojmar.com
DOCUMENT REF: 03/20

